



# General Catalogue

September 2023

*Innovative equipment for the timber industry*

*Designed and built in France. Since 1982.*

Located between Lyon and Geneva,  
A2C innovates, designs, builds, installs and maintains  
a wide range of high-performance, efficient,  
reliable and productive solutions for all wood processing industries.

Our fully qualified and experienced team can provide you  
with the most appropriate solutions for your projects



[www.a2c-fr.com](http://www.a2c-fr.com)

## A2C offers the following four types of solutions:



**TREATMENT**

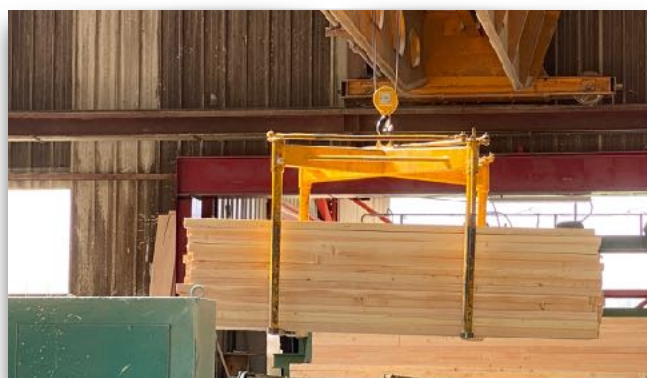

**HANDLING**



**LOGISTICS**

We partner with:



**ROBOTICS**

We partner with:



## Spraying:

Only requires a small volume of treatment product to function. It poses fewer risks to the environment and is legally and administratively less restrictive to operate. However, that's not the only advantage.

Video link



## Spray booth 976-DC

- Safe semi-automatic operation
- Economical
- Streamlined administrative and environmental systems
- Multi-loads
- Side draining at 40°
- Maximum load size 10 x 1.20 x 0.60 m
- Max. capacity 4 tons
- Built-in automatic dosing
- Can be shipped by marine container (French overseas departments and territories, export)



Video link



## Spray booth 976-SP or 976-BDN

- Automatic operation
- Streamlined administrative and environmental systems
- Multi-loads
- 40° lateral + 1.5° longitudinal draining
- Maximum load size 16 x 1.20 x 0.90 m (SP) or 16 x 1.20 x 1.20 m (BDN)
- Max. capacity 8 tons (standard) or 12 tons (reinforced)
- Numerous options available, including two-colour and dual treatment



## Spray booth 976-GH

- Automatic operation
- Can handle high loads (pallet stacks or truss packs)
- Can handle standard loads (with secondary sprayer option)
- Streamlined administrative and environmental systems
- Multi-loads
- Integrated side drain
- Maximum load size 13.5 x 1.20 x 3.55 m
- Max. capacity 3 tons (high loads) and 8 tons (1.20 m high loads with secondary sprayer option)
- Numerous options available, including two-colour and dual treatment

Video link





## Mini-load spraying line at clearance 1052

- Automatic operation
- Streamlined administrative and environmental systems
- Possibility of stacking at in-feed and out-feed
- Maximum load size 0.60 x 0.60 m
- Max. capacity 2 tons
- 45° side draining
- Wide range of configurations and options available



Video link



## Dipping:

From the most basic to the most complex, there's sure to be an A2C dipping tank to suit your needs. All our models feature automatic side draining. The slats do not retain the product = more economical and environmentally friendly.

## Single-frame dipping tank 774-SP or 774-BDN

- Automatic operation
- Single-load
- Side draining at 31° (SP) or 28° (BDN)
- Maximum load size 16 x 1.20 x 0.90 m (SP) or 16 x 1.20 x 1.20 m (BDN)
- Max. capacity 4 tons (SP) or 5 tons (BDN)
- Wide range of configurations and options available



Video link



## Synchronised double-frame dipping tank 774-SP or 774-BDN

- Automatic operation
- The 2 frames always move simultaneously
- Multi-loads
- Side draining at 31° (SP) or 28° (BDN)
- Maximum load size 16 x 1.20 x 0.90 m (SP) or 16 x 1.20 x 1.20 m (BDN)
- Max. capacity 2 x 4 tons (SP) or 2 x 5 tons (BDN)
- Wide range of configurations and options available



## Double independent frame dipping tank 774-BDN

- Automatic operation
- Independent frames for short loads or synchronised frames for long loads
- Multi-loads
- 28° side draining
- Maximum load size 16 x 1.20 x 1.20 m
- Max. capacity 2 x 5 tons
- Wide range of configurations and options available



Video link



## Synchronised triple frame dipping tank 774-SP or 774-BDN

- Automatic operation
- The 3 frames always move simultaneously
- Multi-loads
- Maximum load size 21 x 1.20 x 0.90 m (SP) or 21 x 1.20 x 1.20 m (BDN)
- Max. capacity 3 x 4 tons (SP) or 3 x 5 tons (BDN)
- Side draining at 31° (SP) or 28° (BDN)
- Wide range of configurations and options available



## 774-BDN triple independent frame dipping tank

- Automatic operation
- Independent frames for short loads or synchronised frames for long loads
- Multi-loads
- Maximum load size 21- x 1.20 x 1.20 m
- Max. capacity 3 x 5 tons
- 28° side draining
- Wide range of configurations and options available



## Dipping tank with platform 826

- Automatic operation
- Multi-loads
- 47° side draining
- Maximum load size 14 x 1.20 x 1.20 m
- Max. capacity 10 tons or 12 tons
- Wide range of configurations and options available



Video link





## Single-frame dipping tank 952-SP or 952-BDN

- Automatic operation
- Single-load
- Side draining at 55° (SP) or 51° (BDN)
- Maximum load size 16 x 1.20 x 0.90 m (SP) or 16 x 1.20 x 1.20 m (BDN)
- Max. capacity 4 tons (SP) or 5 tons (BDN)
- Wide range of configurations and options available

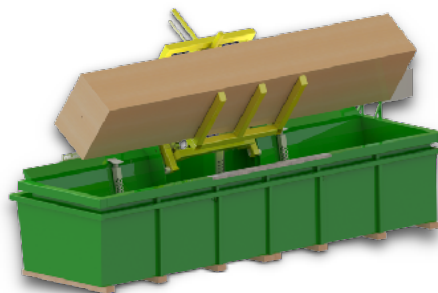

## Synchronised double-frame dipping tank 952-SP or 952-BDN

- Automatic operation
- The 2 frames always move simultaneously
- Multi-loads
- Side draining at 55° (SP) or 51° (BDN)
- Maximum load size 21 x 1.20 x 0.90 m (SP) or 21 x 1.20 x 1.20 m (BDN)
- Max. capacity 4 tons (SP) or 5 tons (BDN)
- Wide range of configurations and options available

Video link



## Double independent frame dipping tank 952-BDN

- Automatic operation
- Independent frames for short loads or synchronised frames for long loads
- Multi-loads
- 51° side draining
- Maximum load size 21- x 1.20 x 1.20 m
- Max. capacity 2 x 5 tons
- Wide range of configurations and options available

Video link



## Triple independent frame dipping tank 952-BDN

- Automatic operation
- Independent frames for short loads or synchronised frames for medium or long loads
- Multi-loads
- 51° side draining
- Maximum load size 21- x 1.20 x 1.20 m
- Max. capacity 3 x 5 tons
- Wide range of configurations and options available



## High speed multi-drain dipping line 966

- Automatic operation
- Step-by-step feed without sprocket or chain
- The loads are drained a number of times after dipping
- 64° multi-station draining
- Can be connected to stacker
- Maximum load size 13.5 x 1.20 x 1.20 m
- Max. capacity 5 tons or 10 tons
- Numerous configuration and options available to suit site and requirements

Video link



## The 926 autoclave system:

**Initial vacuum and impregnation, followed by final vacuum to ensure a treatment tailored to the most demanding requirements, with fully traceable results.**

- Automated multi-program operation
- Multi-loads
- Maximum load size 13.5 x 1.20 x 1.20 m
- Max. capacity 15 tons
- 8° longitudinal draining
- 50° side draining
- No vacuum pump
- Without pressure pump
- Automatic flow dosing
- Multi-point reinforced door
- Multi-colour and multi-treatment available with automatic rinse
- Wide range of configurations and options available

Video link





## Additional equipment for treatment plants:

Simple, high-performance, safe equipment to upgrade your existing treatment equipment and bring it up to standard.

### Automatic dosing kit 923

- Compatible with a wide range of processing machines, regardless of whether or not they are supplied by A2C, and with no need to modify existing equipment
- Maintain treatment solution at a constant level
- Fully automatic
- Reliable, safe and accurate to 0.1%
- Compatible with water, concentrate and, if required, liquid colourant, anti-mould and anti-moss products
- Possibility of multi-unit dosing (with identical or different concentrates)
- Anti-freeze protection of dosing unit
- Traceability and inventory management via colour touch screen
- 220Vac, single phase power supply



### Safety kit for dipping tank 929

- Compatible with all dipping tanks, regardless of whether or not they are supplied by A2C, and with no need to modify existing equipment
- Overflow detection
- Detection of retained liquids
- Audio and visual alarms
- Easy to assemble/dismantle
- 220Vac, single phase power supply



### Thermostatic heating kit for dipping tank 1099

- Detection of retained liquids
- Compatible with all dipping tanks, regardless of whether or not they are supplied by A2C, and with no need to modify existing equipment
- Automatic anti-freeze protection
- Adjustable stainless steel thermostat
- 3 KW stainless steel refractory resistors
- Integrated control cabinet
- Easy to assemble/dismantle
- Stainless steel shock protection for resistors
- Compatible with 1.5, 1.8 m and 2 m high dipping tanks
- Number of variable resistors as required
- 400 V three-phase or single-phase power supply



## Rack cover 981

- Protection from the elements
- Dipping tank protection
- Spray booth protection
- No foundation
- No building permit required (simple declaration)
- Removable structure
- Various design options



## Technical dosing room

- Enclosed, insulated room with containment
- Freeze protection by fan heater and thermostat
- Concentrate storage
- Additive storage
- Automatic dosing cabinet
- Possibility of dosing several products and tanks
- Hydraulic unit for integrated dipping tank(s)
- Customisable according to specifications
- Container rinsing function with recycling available
- Suitable for all treatment equipment models

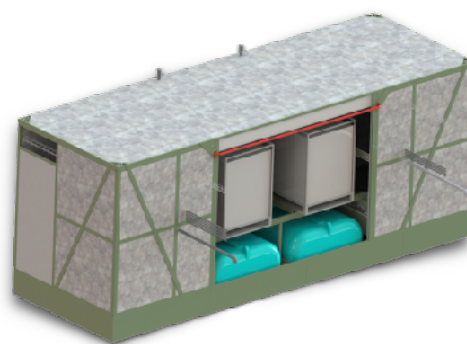

**As a leading and proven manufacturer of wood treatment equipment,  
A2C will be delighted to assist you in all your projects..**







Since 1982, the A2C team has been designing and building a wide range of easy-to-use, efficient and high-performance handling equipment for forklift trucks, overhead travelling cranes or other equipment...

## Matic blade for forklift snow removal 418

- Original forks and carriage
- High-speed assembly and dismantling directly on forklift forks
- Patented ballast counterweight to boost grip and traction
- Blade swivel and oscillation
- Floating blade to suit ground profile
- Safety retraction in the event of impact
- Numerous models and widths adapted to the forklift truck



## Grif matic 722

- Original forks and carriage
- Hydraulically operated central gripper
- Firm support of ridges
- Mounted on frontal, telescopic, lateral and tri-directional forklifts
- Fork lengths 1.20 m or 1.50 m
- Compact, lightweight and extremely robust
- Optimal visibility from the cabin
- Mechanical pre-setting to adapt the tool to wood diameters
- Timber load handling option (vertical gripper retraction)



## Reinforced log grapple 722

- Complete tool with own forks
- Quick-hook mounting
- Hydraulically operated central gripper
- Firm support of ridges
- Designed for heavy-duty, intensive use
- Handling large volumes of wood
- Proven strength



## Matic bucket for bulk products on front loading forklift 439

- High-speed assembly and dismantling directly on forklift forks
- Bulk product handling
- No removal of forks
- Integrated rear cavity keeps products in the bucket during operation (patented system)
- Tipping at the end of the forks = low loss of lift height
- Forklift hydraulic power supply
- Various widths and dimensions available



## Fork expander for stabilizing long loads 780

- High-speed assembly and dismantling directly on the forklift forks or via quick-release coupling
- Temporary carriage widening
- Custom-built
- Quantity of forks and sheaths as required
- Fixed or mobile external forks
- Custom models for tri-directional forklift trucks
- All models are CE-certified
- Compact design
- Minimal front load offset



## Open-bottom waste skip 542

- Rectangular skip
- Waste collection
- Top filling
- Easy and complete emptying from the underside ("base") by remote control
- Opening buffer
- Automatic closing by simply placing on the ground
- Capacity from 540 to 1560 litres
- Exceptional footprint/useful volume ratio
- Can be handled by forklift, pallet truck or pallet stacker
- Solidity and reliability





## Fork mounted sweeper broom 1061

- No modification to forklift
- High-speed assembly and dismantling directly on forklift forks
- Floating position and oscillating action to adapt to ground contours
- Exclusive V-shape to channel waste flow
- Storage stands to protect brooms when not in use



## Forklift 4-fork hoist 761

- For loading dip tanks and spray booths of suitable format
- No crane modification required
- Efficient handling of timber loads
- Does not damage loads
- Max. capacity 3 tons or 5 tons
- Safety, productivity, comfort
- Space-saving
- All 4 forks swivel simultaneously through 90°
- Different models and dimensions



Video link



## Forklift 2-fork hoist 761

- Ultra-fast assembly and dismantling
- No crane modification required
- Efficient handling of timber loads
- Does not damage loads
- Max. capacity 3 tons or 5 tons
- The 2 forks swivel simultaneously through 90°
- Different models and dimensions
- Enables loading of dipping tanks and spray booths of suitable configurations



Video link



## MOB 994 lifting beam for walls

- For mounting on overhead crane hooks or forklift forks
- Adjustable slinging loops
- 2.5 ton capacity
- Length 4m
- Storage support stands
- Possibility of customised design



## Automated overhead travelling crane

- Up to 4 motorised axis
- Rigid vertical telescopic
- Motorized pivoting forked hoists
- Loads can be rotated
- Half loads can be stacked together
- Customised configuration and capacity



## Interlocking conveyor lanes 1068

- Easy-to-use and reliable
- Tough
- Customised configuration and capacity
- Can be easily upgraded
- Low maintenance
- No motorisation



## Unidirectional stepper conveyor

- The loads always move in the same direction
- Simple, highly reliable chainless mechanism
- Loads slide on fixed rails
- Simultaneous movement of all loads without any contact between them
- Loads moved by hydraulic cylinder
- Easy and safe automation
- Very low maintenance
- Very few moving parts
- Compatible with loads on strapped shim rafters
- Automatic re-alignment of loads
- Compatible with different load widths
- Multi-level capability
- Each feed pair moves one load
- Constant, regular pitch
- Absolute repeatability of movements
- Customised configuration and capacity





## Bidirectional stepper conveyor

- Loads can be moved forwards or backwards as required
- Simple, highly reliable chainless mechanism
- Loads slide on fixed rails
- Simultaneous movement of all loads without any contact between them
- Loads moved by hydraulic cylinder
- Easy and safe automation
- Very low maintenance
- Very few moving parts
- Two hydraulic cylinders control feed retraction
- Compatible with loads on strapped shim rafters
- Automatic re-alignment of loads
- Multi-level capability
- Each feed pair moves one load
- Constant, regular pitch
- Absolute repeatability of movements
- Customised configuration and capacity



## Automatic load feeder

- Allows wood to be fed to a workstation (sawing, assembly, etc.) by an operator or automated system
- Single- or two-way rotation
- Double deck
- Infeed and outfeed elevators
- Customisable to your specifications
- Manual or automated wood unloading
- Possibility of slat removal between rows

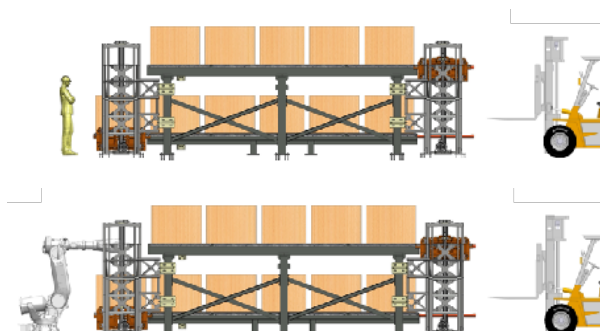

## Manual carousel

- Customised design and manufacture
- Possibility of quick-access locations
- Lifting table option for consistent picking levels
- Significant increase (15-20%) in productivity
- Purely mechanical system
- Low maintenance
- Safety through reduced operator and forklift proximity
- Customisable to specifications



Video link



## Automated Carousel 1056

- Customised design and manufacture
- Possibility of quick-access locations
- Lifting table option for consistent picking levels
- Operating modes for short or long loads
- Significant increase (20-25%) in productivity
- Motorised system
- Low maintenance
- Safety through reduced operator and forklift proximity



Video link



## Scraper conveyor 996

- Custom-built circuit
- Possibility of lifting ramp (with access steps)
- Possibility of inter-connection with other conveyor types (mole, vibratory...)
- With or without automated control
- Simple, cost-efficient mechanism
- High evacuation capacity
- Low maintenance
- Customisable to specifications



## Eccentric conveyor 1025

- For transfer and accumulation of planks
- Electrically driven
- Causes no damage to the wood
- Customisable to specifications



Video link



## Mole 1062

- Easy-to-use, compact equipment
- Hydraulic stepper with no electronic control
- Low maintenance
- Compatible with tough situations
- Quiet system (slow, smooth operation)
- Very compact (no return side)
- Customisable to specifications





**Backing up productive manufacturing with fast, efficient logistics saves time and money...**

### Removable extenders 1008

- Can be adapted to standard platforms and Tautliners
- Increased versatility for platforms and Tautliners
- Quick installation
- Fewer empty runs
- Reduced log transport costs
- Clamping with built-in straps
- Secured by chains between extenders



Video link



### Wall rack 1092

- Each wall can be accessed in the order required
- Individual support for each wall
- Optimum protection
- Safe loading and unloading
- Flexible use
- Capacity can be optimised by adjusting the extenders to suit the thickness of the walls and partitions (50 mm increments)
- Economical
- Easy to use, maintenance-free equipment
- Robust build
- Customisable to specifications
- Can be easily upgraded



### Rack trusses 1092

- Each truss can be accessed in the order required
- Individual support for each truss
- Optimum protection
- Safe loading and unloading
- Flexible use
- Capacity can be optimised by adjusting the extenders to suit the truss thickness (50 mm increments)
- Economical
- Easy to use, maintenance-free equipment
- Robust build
- Customisable to specifications
- Can be easily upgraded
- 

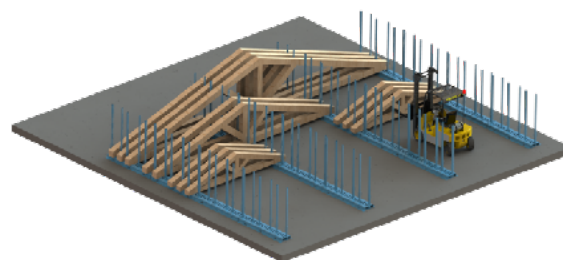

### Wall trolley 1037

- Optimising available storage volume
- Easy access to the wall batch of your choice
- Easy to move manually when empty or loaded
- Folding extenders for space-saving stacking of wall trolleys when empty
- Based on their thickness, restraint stops can easily be fitted at the foot of the walls
- Customisable to specifications



We partner with



[www.auwaerter.com](http://www.auwaerter.com)

## Transmob 1021

- Increase the capacity of your forklift
- Capacity 15 or 24 Tonnes
- For Auwärter XSW and XPBDF baskets
- Exceptional handling qualities
- Standard or high lift path
- Telescopic or non-telescopic model
- With or without twistlocks
- Allows you to optimise your scheduling without depending on your semi-trailer availability
- Empty platforms positioned at lowest point
- Full platforms lifted to maximum height
- Wide range of configurations and options available



Video link



## Transcontainer 1021

- 40ft Container fully loaded in 5 minutes
- An easy to use, fast and safe system
- Integrated levelling and clamping in relation to the container
- In the event of several mobile loading tables, this system enables the preparation of several packs simultaneously, ready to be loaded in a single operation based on the container in question
- In the case of freight on single-use pallets, container unloading can be mechanised by another transcontainer at the destination site, as the motorisation is reversible. This scenario is therefore ideal for frequent shuttles between sites
- Can also handle Auwärter XSW and XPBDF baskets
- 24 ton capacity



Video link



## Protecmob 1051

- Effective, durable and reusable protection of the contents of your Auwärter baskets
- For secure storage of finished walls in your yard or building sites
- Easy to stack together for grouping of site returns
- Easy handling of the tarpaulins using a winding handle
- Can be branded in line with your signage for visible, effective



Video link





We partner with



www.imaxpro.be



## Robotmob 1 1081

- Easy programming to switch from one wall model to another by processing BTL files
- MOB wall signage
- Motorised wall feed
- 1 robot = 1 function (panelling - nailing - machining)
- Configured to suit your needs
- Easy to use
- Reliable
- High productivity
- Precision



## Robotmob twin 1081

- Easy programming to switch from one wall model to another by processing BTL files
- Alternating manual and automated work on two workstations
- Configured to suit your needs
- Numerous options available
- Versatile
- Easy to use
- Reliable
- Upgradeable
- High productivity
- Precision
- Customisable to specifications



## Robotpli 1081

- Easy programming to switch from one wall model to another by processing BTL files
- Manufacture/machining of CNT walls
- Configured to suit your needs
- Numerous options available
- Versatile
- Easy to use
- Reliable
- Upgradeable
- High productivity
- Precision
- Customisable to specifications



## Robotérimaire 1081

- Repetitive tasks
- Customisable to specifications
- Versatile
- Easy to use and program
- Reliable
- Integrated perimeter security
- Quick and easy to set up
- Rental contract option



## Track

- Allows the robot to move lengthways to increase its working area
- Integrated cable chain
- Silent trolley movement
- Long lengths option (up to 42m)
- Compact width
- Quick and easy to set up
- Top cowling
- Can be adapted to different robots
- Possibility of 2 robots per track
- Customisable to specifications



## Tilt table

- Workstation for different tasks (MOB, CNT, etc.)
- Repeatable movements
- Rigid structure
- Upwards and downwards movements
- Hydraulic movements
- Can be controlled by automated system
- Customisable to specifications







Treatment



Handling



Logistics



Robotics



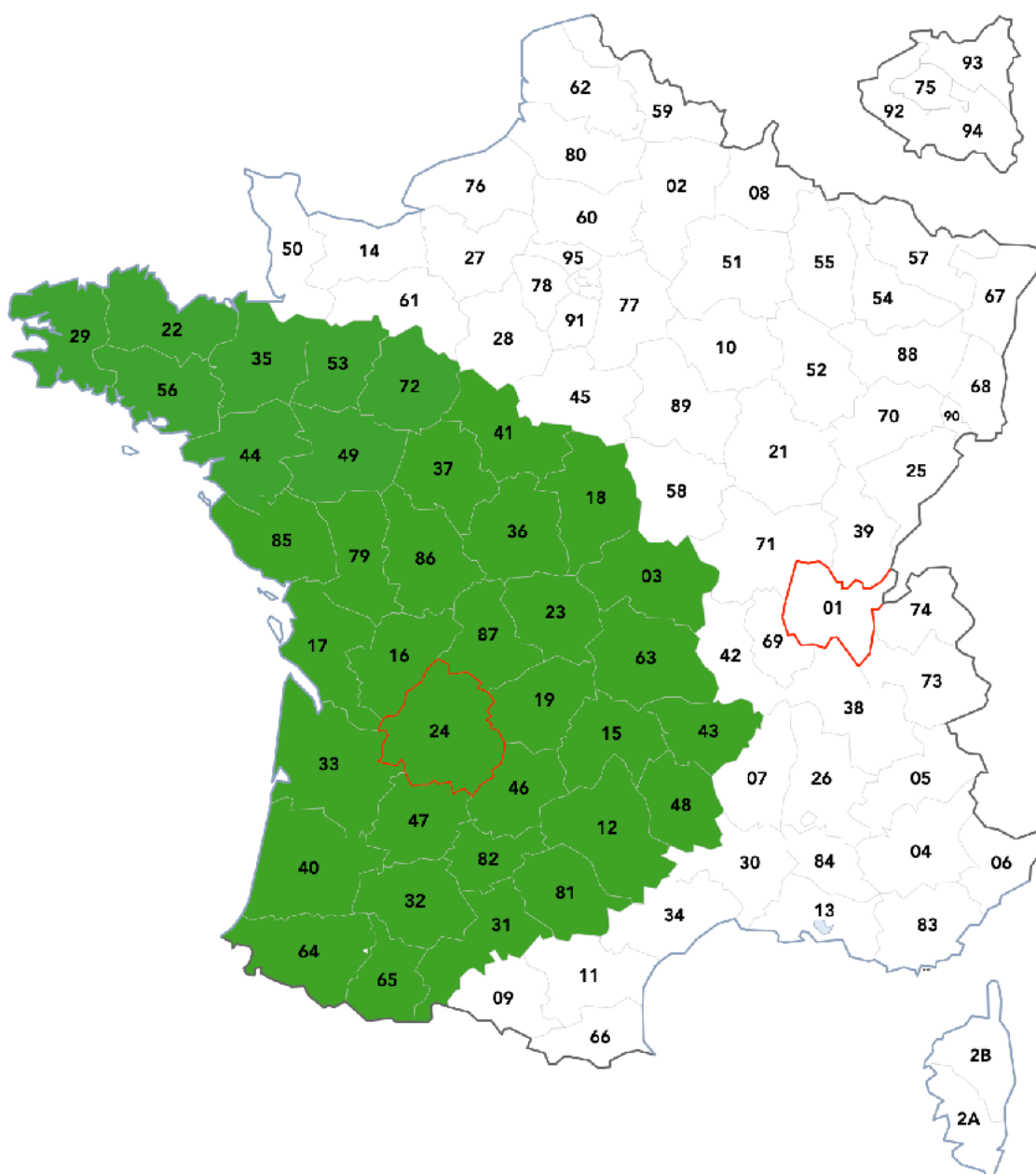

**A2C** - White zone sector - North, East and South-East sectors:

[commercial@a2c-fr.com](mailto:commercial@a2c-fr.com) and/or +33 (0) 4 79 87 65 11

1 chemin du Nerbier - Le Dombier - Le Petit Abergement - 01260 Haut Valromey

**Jean DEVIEILLETOILE** - Green zone sector - West and South-West sectors, overseas, UK:

[j.devieilletoile@a2c-fr.com](mailto:j.devieilletoile@a2c-fr.com) and/or +33 (0) 6 74 10 66 76

**Frédéric WEIDISCH** - Marketing Belgium, Luxembourg, Germany, Austria, Netherlands:

[f.weidisch@a2c-fr.com](mailto:f.weidisch@a2c-fr.com) and/or +32 493 19 78 64

**Christian MICHOU** - Marketing French-speaking Switzerland, Ticino:

[christian.michoud@torex.ch](mailto:christian.michoud@torex.ch) and/or +41 79 503 17 62

**Markus HESS** - Marketing German-speaking Switzerland:

[markus.hess@torex.ch](mailto:markus.hess@torex.ch) and/or +41 79 321 70 84