



**SMALL DISPLAY,
BIG CONVENIENCE!**

**OLED
DISPLAY**



SMARAF S-GP200

SMARAF GUARD PATROL SYSTEM
BEST SOLUTION TO MANAGE YOUR GUARDS REMOTELY

WWW.SMARAF.COM

Online software

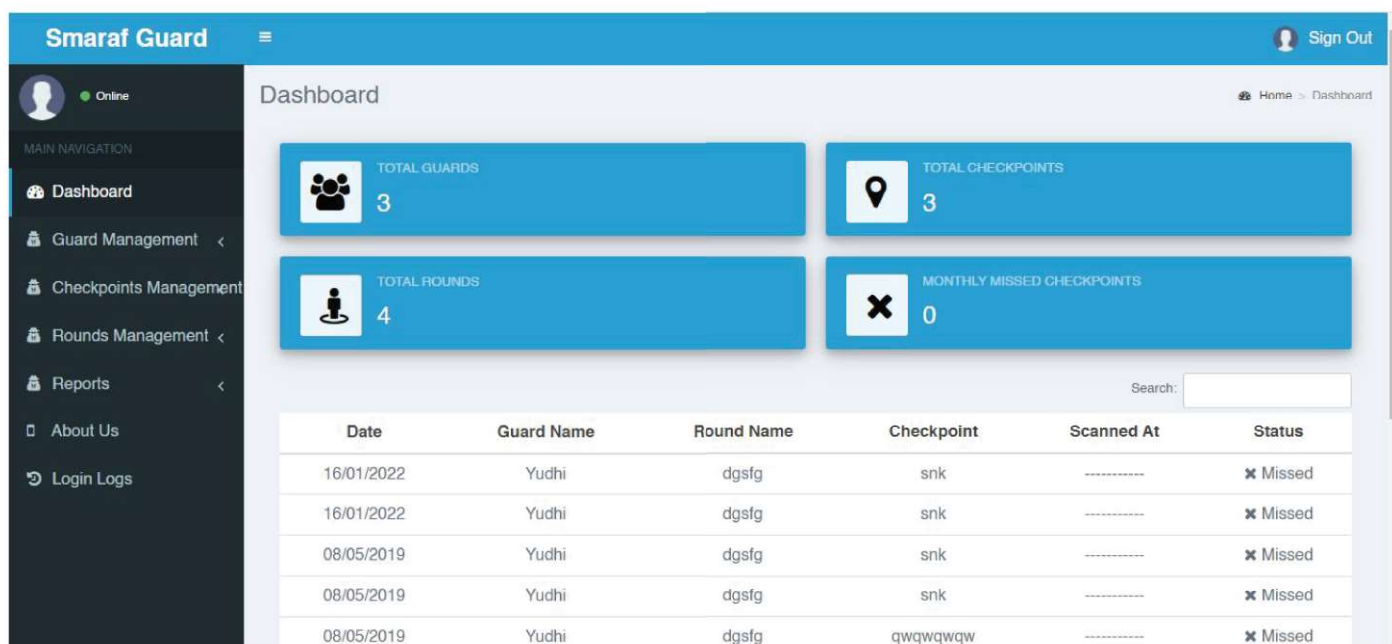

Smaraf Guard Patrol management software take a very important role in guard tour system. Allow to layout checkpoint settings, schedule setup, shift arrangement and download data from guard patrol reader , finally generate wide variety report as user's query demand .

Features

- monitor guards from anywhere
- easy to use and simple to install
- easy wireless set-up
- no software installation or program downloads required
- the handset is manufactured to IP67 standard
- up to 10 days battery life
- SIM card with 12 months free SIM management (Democratic Republic of the Congo)
- ID points are water proof and wireless
- unique ID point holder design
- unlimited handsets and points per site
- unlimited sites per system
- full access to all online features at no additional cost
- full online reporting
- receive live notifications into the platform
- automated reports
- email and/or SMS alert notifications
- rentals available



Key Features

- 125KHz RFID proximity reading
- GPRS real time transmission
- OLED displays running and operations
- SOS panic alarm
- Mass storage capacity
- Impact recording
- WiFi transmission can be tailored
- Auto sync date and time with server



SMARAF S-GP200 is a real time guard tour system that adopts 2G communication technology, which is able to send data from the patrol handheld reader to server immediately. The OLED display offers the info of connection status, network configuration, and other operations.

This series of patrol handheld reader can be widely used for employee control areas, like security, cleaning, factory, railways, airports, ports, maintenance, client who want to improve their management actively and etc.

Layout

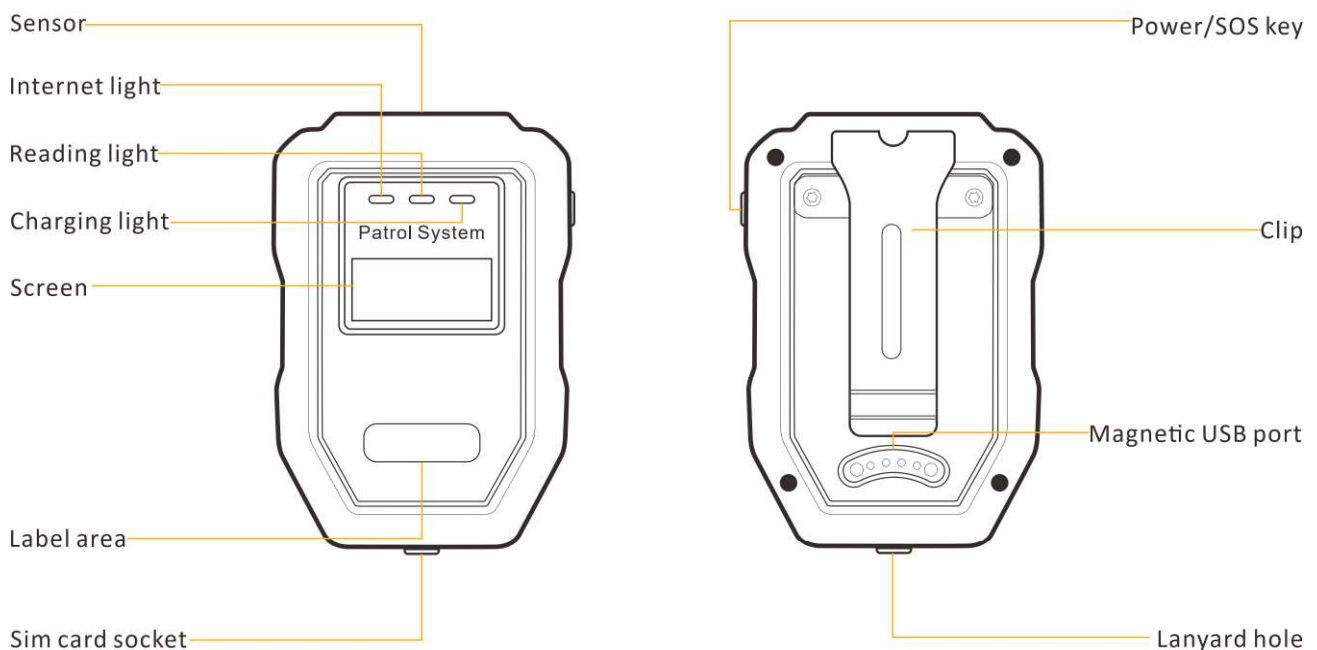

Specification

Network supported bands	2G or WIFI	GSM: 850/900/1800/1900MHz 802.11a/b/g/n
Display	Size	0.9 inch OLED screen
	Pixels	128*64px
Reader information	Reading technology	125KHz RFID (EM-ID tag)
	Material	ABS plastic shell, rubber handle
	Prompt	LED+Vibration+display
	Memory	80,000 logs
	Impact Record	32,000 logs
	SIM card	Nano card
	IP rating	IP67
Key	Booting/Shut down	Long press 3 seconds
	SOS alarm	Enter the config page long press 3 seconds
Wired communication	USB	Anti-vandal magnetic USB cable
Battery	Capacity	1200mAh rechargeable li-ion battery
	Working time	20 hours
	Working consumption	60mA
	Stand-by	10mA
	Charging time	1.2-2 hours(5V/1A)
Size	Dimension	82*52*22mm
	Weight	73g
Work environment	Humidity	30% to 95%
	Temperature	-20 to 70°C

Working Map

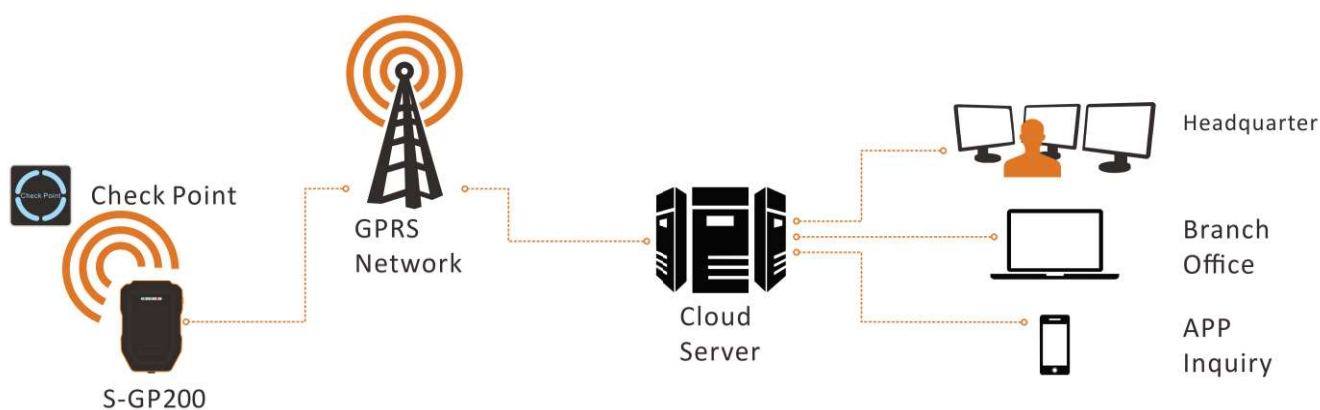

Accessory

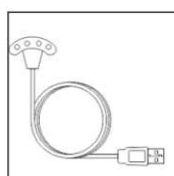

USB cable

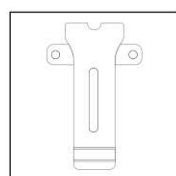

Clip



Manual