

## QUESTIONS ON SAFETY?

### WE'RE HERE TO ANSWER.



Blue Capsule's subterranean module is the *only* one compatible with chemical industry plants in terms of both capacity and safety.

With a Blue Capsule small modular reactor, core melt is, in practice, impossible because Blue Capsule features TRISO fuel (the most robust fuel in the world) in a naturally circulating sodium pool that operates at atmospheric pressure.

## QUESTIONS ON DESIGN?

### WE'RE HERE TO EXPLAIN.



Blue Capsule features two mature technologies with existing supply chains, combined in a robust reactor design.

Our innovation is simple: we combine sodium-cooled and high-temperature reactor (HTR) technologies. Maximum efficiency. Minimum risk.

## CONTACT US:

@ [press@bluecapsule-technology.com](mailto:press@bluecapsule-technology.com)

 Technopôle de l'Arbois, Avenue Louis Philibert,  
13290 Aix-en-Provence, FRANCE

 [bluecapsule-technology.com](http://bluecapsule-technology.com)

 [linkedin.com/company/bluecapsule-technology](https://www.linkedin.com/company/bluecapsule-technology)

## WHO'S BEHIND BLUE CAPSULE?

BLUE CAPSULE IS A **FRENCH TECHNOLOGY**  
WITH AN **INTERNATIONAL TEAM** OF STAFF.

## MEET OUR FOUNDERS:



Edouard Hourcade  
President & co-founder



Alexey Likhov  
CTO & co-founder



Alexis Burdeau  
CFO & co-founder

WE'RE A **FRANCE 2030 LAUREATE** IN THE  
CALL FOR "INNOVATIVE NUCLEAR REACTORS"



## OUR PARTNERS SO FAR:



# BLUE CAPSULE

TECHNOLOGY



## UNIQUE NUCLEAR HEAT FOR OUR PARTNERS IN INDUSTRY

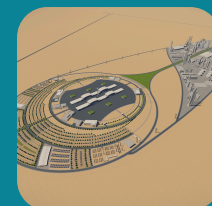
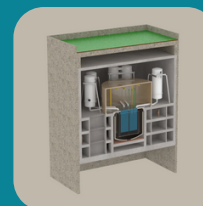

[bluecapsule-technology.com](http://bluecapsule-technology.com)



## WHAT DOES BLUE CAPSULE DO?

WE'RE DEVELOPING A **SMALL MODULAR REACTOR** TO PROVIDE HEAT AND STEAM FOR OUR PARTNERS IN INDUSTRY.



Blue Capsule is a low-carbon, local solution for hard-to-abate sectors where electrification isn't possible.

1 capsule = up to 150 MWth of 750°C industrial-grade heat. Each capsule also yields high-temperature steam and 50 MWe of electricity if needed.

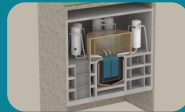

## HOW ARE WE FINANCING THE PROJECT?

OUR INVESTORS SEE POTENTIAL ACROSS EUROPEAN & GLOBAL MARKETS.



**eren** **cea** investissement  
AMORÇAGE TECHNOLOGIQUE



The global market for industrial heat is roughly 57,000 TWh. That's 1.5 times China's primary energy demand.



The European market for industrial heat is roughly 1200 TWh, equating to > 1000 Blue Capsule modules.

## WHY IS BLUE CAPSULE SO EFFECTIVE?

OUR UNIQUE SOLUTION **AVOIDS LOSSES** IN DELIVERING HEAT TO YOUR SITE.

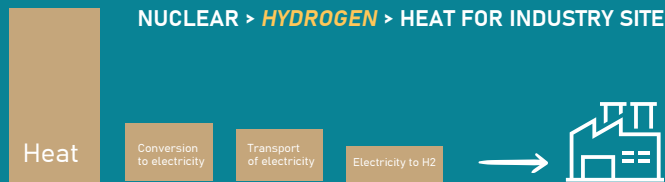
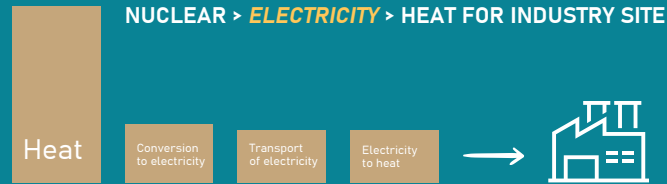

**BLUE CAPSULE**  
TECHNOLOGY



## WHO CAN DEPLOY BLUE CAPSULE?

INDUSTRY NEEDS RELIABLE HEAT, STEAM & ELECTRICITY. WE STAND READY TO SUPPORT **MULTIPLE INDUSTRY SECTORS**.

How much **ammonia** do you produce? Blue Capsule allows you to keep existing ammonia production and fully decarbonise it. No more dependence on fossil fuels.



As a major **soda ash** production site, you need to decarbonise in line with (inter)national regulations, while staying competitive. Blue Capsule can cover your needs and help keep plants operational.



Whether pyrolysis, steam methane reforming, or high-temperature electrolysis, your process for **hydrogen** is important. Blue Capsule will reduce the carbon footprint of H2 production.

